

# RLCD-FRAME2-K1/K2 Installation Instruction

## Included in this package

(4) 12-24 5/8" Pan Head Screws



(4) M5 Pan Head Screw



(4) 10-32 5/8" Pan Head Screws



(6) M4 Pan Head Screw



(1) Hanging Frame ◆

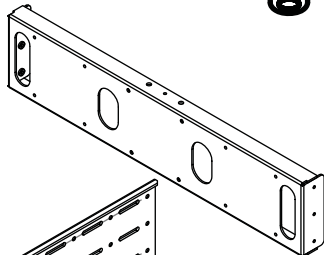

(2) L Brackets ❖

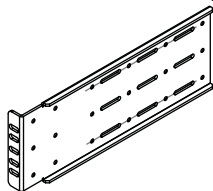

(1) VESA Monitor Adapter Plate ◆



(1) Monitor Arm Bracket ☒



(1) Fastening Bracket ☒

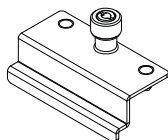

(1) Monitor Arm ⌘

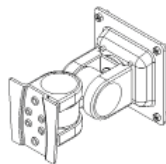

## Installation Steps

**Step 1.** Attach a Monitor Arm Bracket ☒ to a Hanging Frame ◆ using (4) M5 pan head screw to secure the bracket

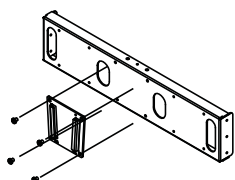

**Step 2.** Attach two L Brackets ❖ to each side of the hanging frame ◆. Use (6) M4 Pan head screws to secure the brackets ❖ to the hanging frame ◆.

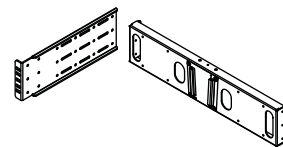

**Step 3.** Carefully align the mounting holes on the assembled hanging frame ◆ to the mounting holes on a rack. Depending on the types of hole threading done on the rack, use either 10#-32 5/8" pan head screws or 12#-24 5/8" pan head screws to secure the assembled frame unit on to the rack.

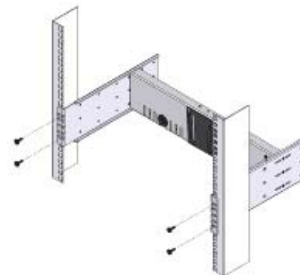

**Step 4.** Note: For a 19" or larger LCD monitor installation, a VESA Monitor Adapter Plate ◆ (A 100mm\*100mm to 75mm\*75mm metal adapter plate) might be needed to be installed in between the monitor arm unit and the LCD monitor. First, attach a monitor arm unit to the LCD monitor. Next, use (4) M4 Hex Head screws to secure the monitor arm unit to the back of the LCD monitor. Installation of a VESA Monitor Adapter Plate is optional.

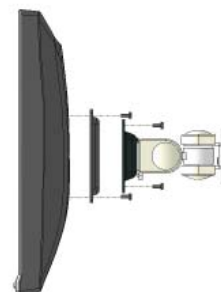

**Step 5.** Carefully, slide the monitor unit into the monitor arm bracket as shown on the left. Next, Secure the monitor arm by installing a fastening bracket ☒ as shown on the left. Tighten the thumb screws on the top of the fastening bracket.

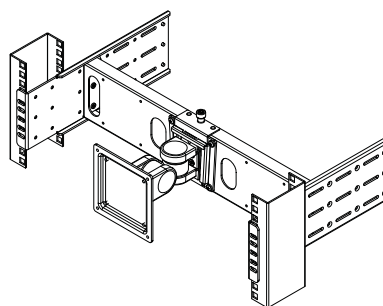
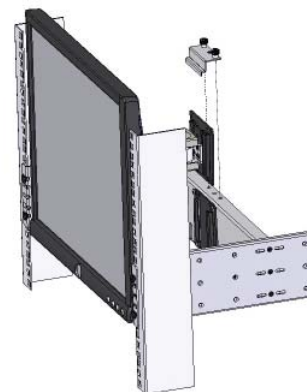

Installation Complete.